



**Installation Manual**  
**Double DIN Kit**

Part No.: CT23MB01A

**Mercedes Viano/Vito 2006 >**  
**Mercedes A-Class 2004 - 2012**  
**Mercedes B-Class 2005 - 2011**

Compatible with double DIN devices

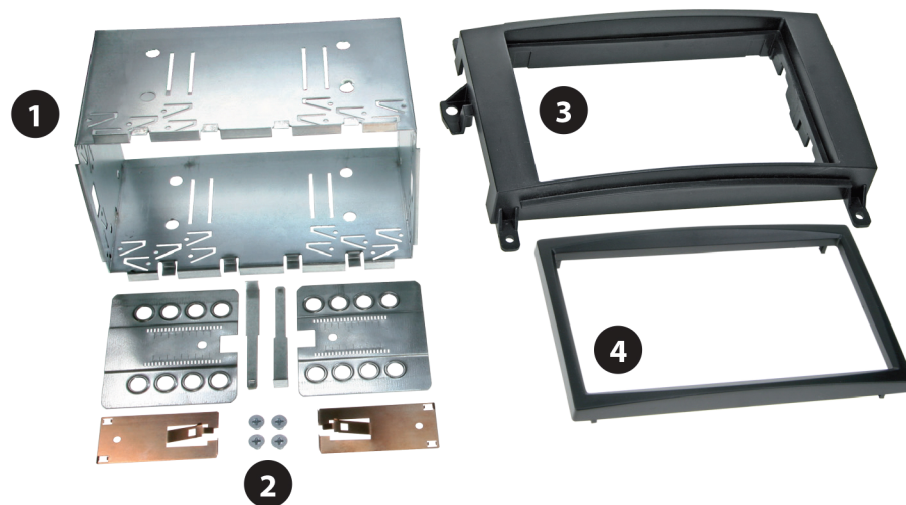

Double DIN Set contents

- (1) Metal Frame
- (2) Installation Kit
- (3) Facia Plate
- (4) Trim Frame



1. Vehicle with OEM head unit.

Remove the trim panel surrounding the radio.



2. Remove the four screws at the top and bottom of OEM head unit.

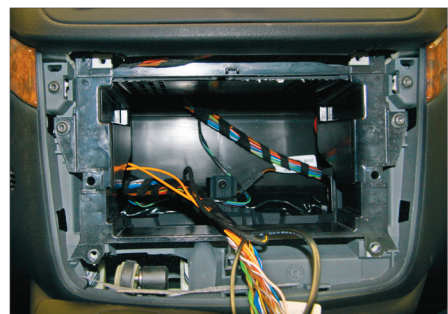

3. Remove the OEM head unit.

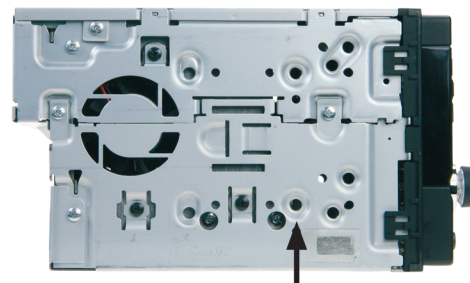

Mount the metal brackets with the double DIN head unit

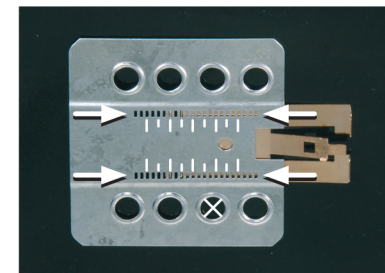

*The position of the copper coloured holder can be adjusted to your needs for perfect fit. (see sample)*



4. Place the fascia plate on the dashboard. Fix it with the four original screws.

Push the Metal Frame into the fascia plate.

Connect all required circuit points and push the double DIN head unit in the metal frame until it snaps in.

Place the trim frame.

Reinstall everything in reverse order to finish installation.