

PRODUCT SPECIFICATION

Work for	Mobile phone and digital product
Input voltage	DC 5V
Input current	800mA(MAX)
Output voltage	DC 5V
Output current	2A, 2A(MAX)
Capacity	6000mAh
Product weight	165g
Product dimension	116(L)×68(W)×15.5(H)mm
Operating temperature	-10℃~60℃
Storage temperature	-10℃~45℃

MAINTENANCE

Keep your power bank operating to the fullest potential, by following the below steps:

1. Re-charge your power bank once every three months when it is not in use.
2. Keep the power bank away from any moist environment and corrosive material.
3. Never wash the power bank with any chemicals, soaps or detergents.

USER MANUAL

Rechargeable Battery Pack

CE FC RoHS

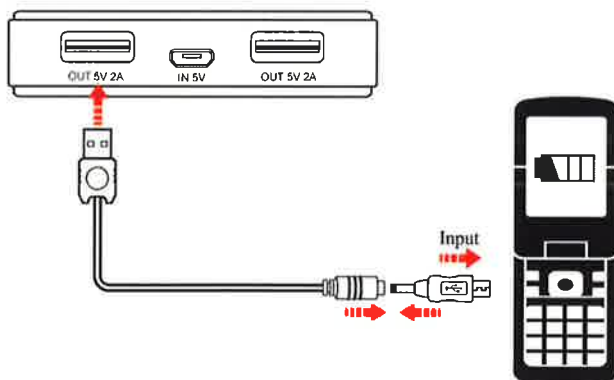

HOW TO USE

- Simply using the attached USB cable to charge the digital product, one end of the USB cable connect with the "OUT" port of the power bank, another end connect with the digital product with the converted tip. press "⏻" button, it will start to charge and the working indicator will indicate the charging process.
- Finishing charging or failing to connect the digital product, the LED indicator will stop flashing. And the power bank will turn off automatically after 15 seconds.
- The LED battery level indicator (LED display) will show the remain power percentage. When the LED battery level indicator (LED display) show "LO" means low power, and need to charge the power bank in time.

Note If the product is overloaded the safety cut-out will kick in and the power bank will go into protected mode. To return to normal mode, simple charge the power bank. If charge iPad, please try to use iPad original cable to charge.

CE FC RoHS

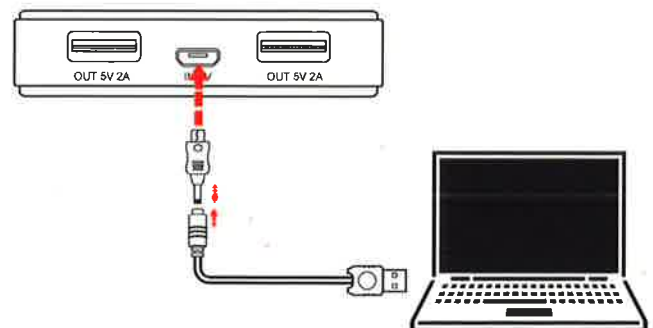

HOW TO CHARGE THE POWER BANK

- The "IN" port is the charging port of the power bank. The working indicator will flash when charge the power bank, and the LED battery level indicator (LED display) will show 99 to indicate full charging. And the working indicator will light on.

UNIT VIEW DESCRIPTION

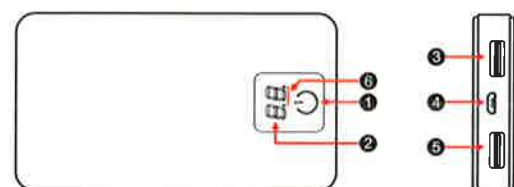

- ① Turn ON Button ② LED display ③ USB output port 1
- ④ DC5V input port ⑤ USB output port 2 ⑥ Working indicator